

CORNER RECORD

COUNTY OF MADERA T. 6S R. 21E M.D. MERIDIAN CALIFORNIA
 CORNER TYPE: GOV'T. CORNER MEANDER RANCHO CONTROL OTHER
 CORNER IDENTIFICATION - DATE OF VISIT 6-27 19 90

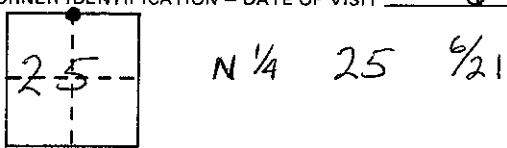

CORNER - LEFT AS FOUND FOUND AND TAGGED REESTABLISHED OBLITERATED CORNER REBUILT

PHYSICAL DESCRIPTION OF CORNER FOUND; EVIDENCE AND METHOD USED TO IDENTIFY OR REESTABLISH
3 1/4" ALUM. DISC IN 2 1/2" ALUM PIPE. DEPT. AG. USFS LS4689 SET 1983
STAMPED N 1/2 25 1/2. IN MOUND OF ROCKS 30 SOUTH OF FOREST BOUNDARY MARKER POST

PHYSICAL DESCRIPTION OF MONUMENTS REBUILT OR PERPETUATED

CALIFORNIA COORDINATE SYSTEM ORDER: FIRST SECOND THIRD
 STATIONS USED: NGS (USC & GSI) STATE COUNTY OTHER STATION _____ STATION _____
 ZONE _____ ELEVATION _____ NORTHINGS (Y) _____ EASTINGS (X) _____

SKETCH: (Include reference tie or witness points, remarks and topo of area)

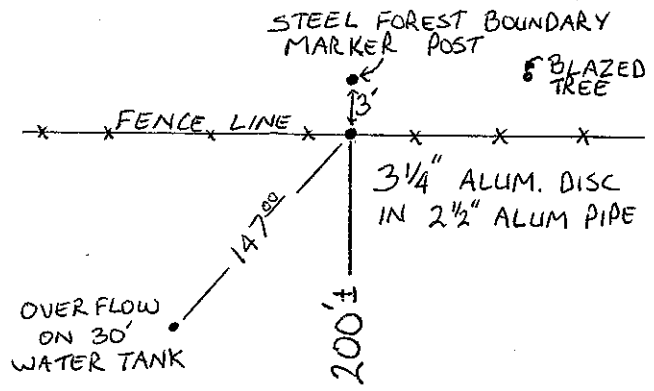

3/10 mi to FORK @ -> CHURCH CAMP BARRACKS
1 3/4 mi. to HWY 41 ->

GRAVEL ROAD

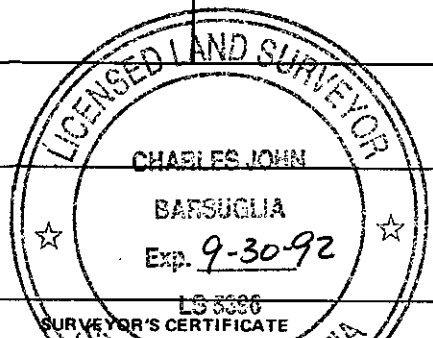

LS 3386
 SURVEYOR'S CERTIFICATE
 THIS CORNER RECORD WAS PREPARED BY ME OR UNDER MY DIRECTION IN CONFORMANCE WITH THE LAND SURVEYORS ACT ON 7-9 19 90 FOR THE STATE OF CALIFORNIA
 SIGNED: Charles John Barsuglia
 L.S. or R.C.E. No.: 5396

COUNTY SURVEYOR'S CERTIFICATE
 THE CORNER RECORD WAS RECEIVED 7-11 19 90
 AND EXAMINED AND FILED 7-17 19 90
 BY: Dove Stinson
 TITLE: DOVE STINSON
MADERA COUNTY ENGINEER 209-675-7817
 DOCUMENT No. _____
 STATEMENT ON BACK OF SHEET YES NO

SEAL