

# CORNER RECORD

COUNTY OF Modoc T. 6 S. R. 21 E. M.D.B.M. MERIDIAN CALIFORNIA  
 CORNER TYPE: GOVT. CORNER  MEANDER  RANCHO  CONTROL  OTHER   
 CORNER IDENTIFICATION — DATE OF VISIT September 1977

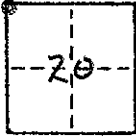

N.W. Corner  
section 20 T6S, R21E, M.D.B.M.

CORNER — LEFT AS FOUND  FOUND AND TAGGED  REESTABLISHED OBLITERATED CORNER  RESULT

PHYSICAL DESCRIPTION OF CORNER FOUND; EVIDENCE AND METHOD USED TO IDENTIFY OR REESTABLISH

x in 6'x4' Rock bolder with witness pipe 0.4' west  
tagged L.S. 2737

PHYSICAL DESCRIPTION OF MONUMENTS RESULT OR PERPETUATED

Cut x Reference marks in Rocks as shown in  
sketch below.

CALIFORNIA COORDINATE SYSTEM ORDER: FIRST  SECOND  THIRD   
 STATIONS USED: NGS (USC & GSI)  STATE  COUNTY  OTHER  STATION \_\_\_\_\_ STATION \_\_\_\_\_  
 ZONE \_\_\_\_\_ ELEVATION \_\_\_\_\_ NORTHINGS (Y) \_\_\_\_\_ EASTINGS (X) \_\_\_\_\_

SKETCH: (Include reference tie or witness points, remarks and topo of area)

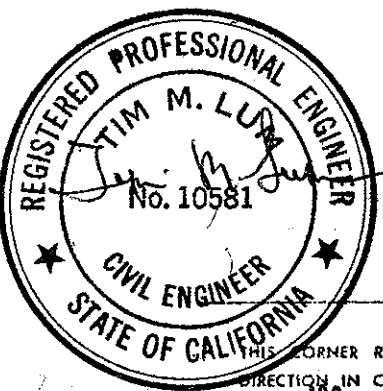
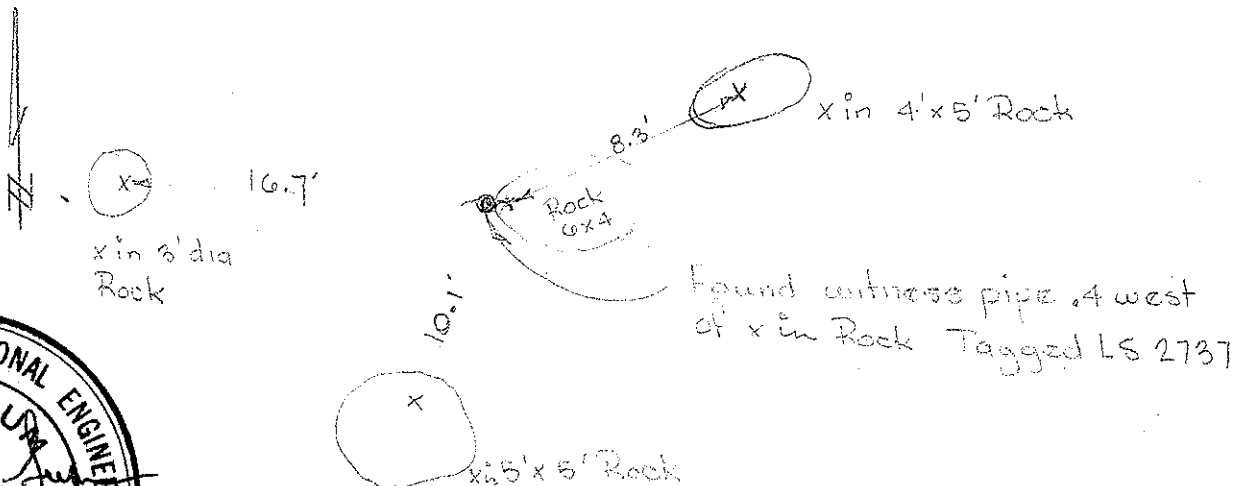

**SURVEYOR'S CERTIFICATE**  
 THIS CORNER RECORD WAS PREPARED BY ME OR UNDER MY DIRECTION IN CONFORMANCE WITH THE LAND SURVEYORS ACT ON Mar 21 1978  
 SIGNED: Tim M. Lum  
 R.C.E. No.: 10581

**COUNTY SURVEYOR'S CERTIFICATE**  
 THE CORNER RECORD WAS RECEIVED 3-23- 1978  
 AND EXAMINED AND FILED mar 23 1978  
 BY: A. Grote  
 TITLE: County Engineer  
 DOCUMENT No. 78-02-01

SEAL

STATEMENT ON BACK OF SHEET YES  NO