

CORNER RECORD

COUNTY OF Madera T. 9 S R. 15 E Mt. Diablo MERIDIAN CALIFORNIA

CORNER TYPE: GOV'T. CORNER MEANDER RANCHO CONTROL OTHER

CORNER IDENTIFICATION — DATE OF VISIT September 9, 1976

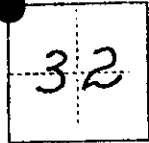

Northwest corner Section 32

CORNER — LEFT AS FOUND FOUND AND TAGGED REESTABLISHED OBLITERATED CORNER REBUILT

PHYSICAL DESCRIPTION OF CORNER FOUND; EVIDENCE AND METHOD USED TO IDENTIFY OR REESTABLISH

Found 80^D nail with 3/4" flat head at 0³ below Asph Road.

PHYSICAL DESCRIPTION OF MONUMENTS REBUILT OR PERPETUATED

CALIFORNIA COORDINATE SYSTEM ORDER: FIRST SECOND THIRD
STATIONS USED: NGS (USC & GS) STATE COUNTY OTHER STATION _____ STATION _____
ZONE _____ ELEVATION _____ NORTHINGS (Y) _____ EASTINGS (X) _____

SKETCH: (Include reference tie or witness points, remarks and topo of area)

- 51.79 Southwest from nail & shiner in telephone post.
- 47.73 Northeast from nail & shiner in power pole.
- 42.87 Northwest from 3" galvanized brace postmark at 3⁰ above ground.

NOTE: THIS RECORD WAS FILED MORE THAN 90 DAYS AFTER THE INDICATED DATE OF VISIT.

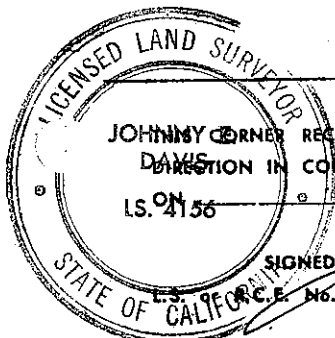

SURVEYOR'S CERTIFICATE

JOHNNY CORNER RECORD WAS PREPARED BY ME OR UNDER MY DIRECTION IN CONFORMANCE WITH THE LAND SURVEYORS ACT

LS. 4156

SIGNED: *John E. Davis*

No. 4156

4156

SEAL

COUNTY SURVEYOR'S CERTIFICATE

THE CORNER RECORD WAS RECEIVED FEB 7 19 79 AND EXAMINED AND FILED _____ 19 _____

BY: _____

TITLE: MADERA COUNTY ENGINEER

DOCUMENT No. _____

STATEMENT ON BACK OF SHEET

YES

NO