

CORNER RECORD

COUNTY OF Madera T. 65 R. 20E MD MERIDIAN CALIF.

CORNER TYPE: GOV'T CORNER  MEANDER  RANCHO  CONTROL  OTHER

CORNER IDENTIFICATION --- DATE OF VISIT Sept 30 19 74

\* 36 -

W 1/4 Cor., Sec. 36, T. 65., R. 20E., M.D.B & M

CORNER -- LEFT AS FOUND  FOUND & TAGGED  REESTABLISHED OBLITERATED CORNER   
REBUILT

PHYSICAL DESCRIPTION OF CORNER FOUND; EVIDENCE & METHOD USED TO IDENTIFY OR REESTABLISH:

*Found 1" iron pipe in rock mound tagged L52737*

PHYSICAL DESCRIPTION OF MONUMENTS REBUILT OR PERPETUATED:

*N.A.*

CALIFORNIA COORDINATE SYSTEM ORDER: FIRST  SECOND  THIRD   
STATIONS USED: NOS (USC & GS)  STATE  COUNTY  OTHER  STATION \_\_\_\_\_  
STATION \_\_\_\_\_ ZONE \_\_\_\_\_ ELEVATION \_\_\_\_\_ NORTHINGS (Y) \_\_\_\_\_  
EASTINGS (X) \_\_\_\_\_

SKETCH: (INCLUDE REFERENCE TIE OR WITNESS POINTS, REMARKS AND TOPO OF AREA)

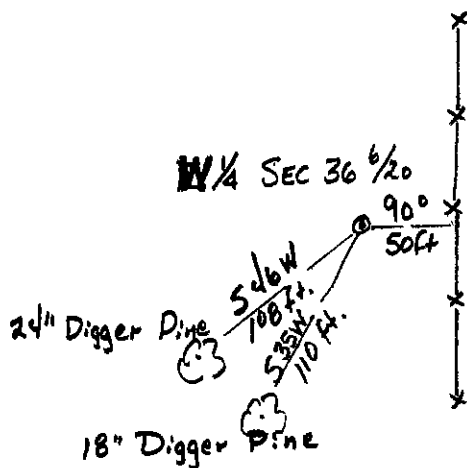

SURVEYOR'S CERTIFICATE

THIS CORNER RECORD WAS PREPARED BY ME OR UNDER MY DIRECTION IN CONFORMANCE WITH THE LAND SURVEYORS ACT ON

Oct 11 19 74

SIGNED: Charles Victor Sikora

L.S. or R.C.E.

524/26

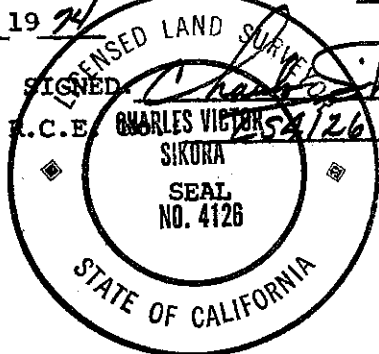

COUNTY SURVEYOR'S CERTIFICATE

THE CORNER RECORD WAS RECEIVED Oct 15 19 74 and examined and filed Oct 24, 1974

BY: Albert O. Grote

TITLE: County Engineer

DOCUMENT No. 74-25-6

STATEMENT ON BACK OF SHEET

YES  NO