

CORNER RECORD

COUNTY OF MADERA T. 6 R. 20 MERIDIAN CALIFORNIA

CORNER TYPE: GOVT. CORNER  MEANDER  RANCHO  CONTROL  OTHER

CORNER IDENTIFICATION - DATE OF VISIT 6-13 1959

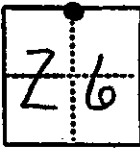

N 1/4 SEC. 26 1/20

CORNER - LEFT AS FOUND  FOUND AND TAGGED  REESTABLISHED OBLITERATED CORNER  REBUILT

PHYSICAL DESCRIPTION OF CORNER FOUND; EVIDENCE AND METHOD USED TO IDENTIFY OR REESTABLISH

Fd 2" I.P.

PHYSICAL DESCRIPTION OF MONUMENTS REBUILT OR PERPETUATED

CALIFORNIA COORDINATE SYSTEM ORDER: FIRST  SECOND  THIRD   
STATIONS USED: NGS (USC & GS)  STATE  COUNTY  OTHER  STATION \_\_\_\_\_ STATION \_\_\_\_\_  
ZONE \_\_\_\_\_ ELEVATION \_\_\_\_\_ NORTHINGS (N) \_\_\_\_\_ EASTINGS (E) \_\_\_\_\_

(Fold)

SKETCH: (Include reference tie or witness points, remarks and topo of area)

B.T. S.E.

COPIED FROM W.O. GENTRY FIELD BOOK  
BY JONES & SNYDER

SURVEYOR'S CERTIFICATE

THIS CORNER RECORD WAS PREPARED BY ME OR UNDER MY DIRECTION IN CONFORMANCE WITH THE LAND SURVEYORS ACT ON \_\_\_\_\_ 19\_\_\_\_

SIGNED: \_\_\_\_\_

L.S. or R.C.E. No. \_\_\_\_\_

SEAL

COUNTY SURVEYOR'S CERTIFICATE

THE CORNER RECORD WAS RECEIVED \_\_\_\_\_ 19\_\_\_\_ AND EXAMINED AND FILED \_\_\_\_\_ 19\_\_\_\_

BY: \_\_\_\_\_

TITLE: \_\_\_\_\_

DOCUMENT No. \_\_\_\_\_

STATEMENT ON BACK OF SHEET

YES  NO

# W.O. GENTRY FIELD BOOK

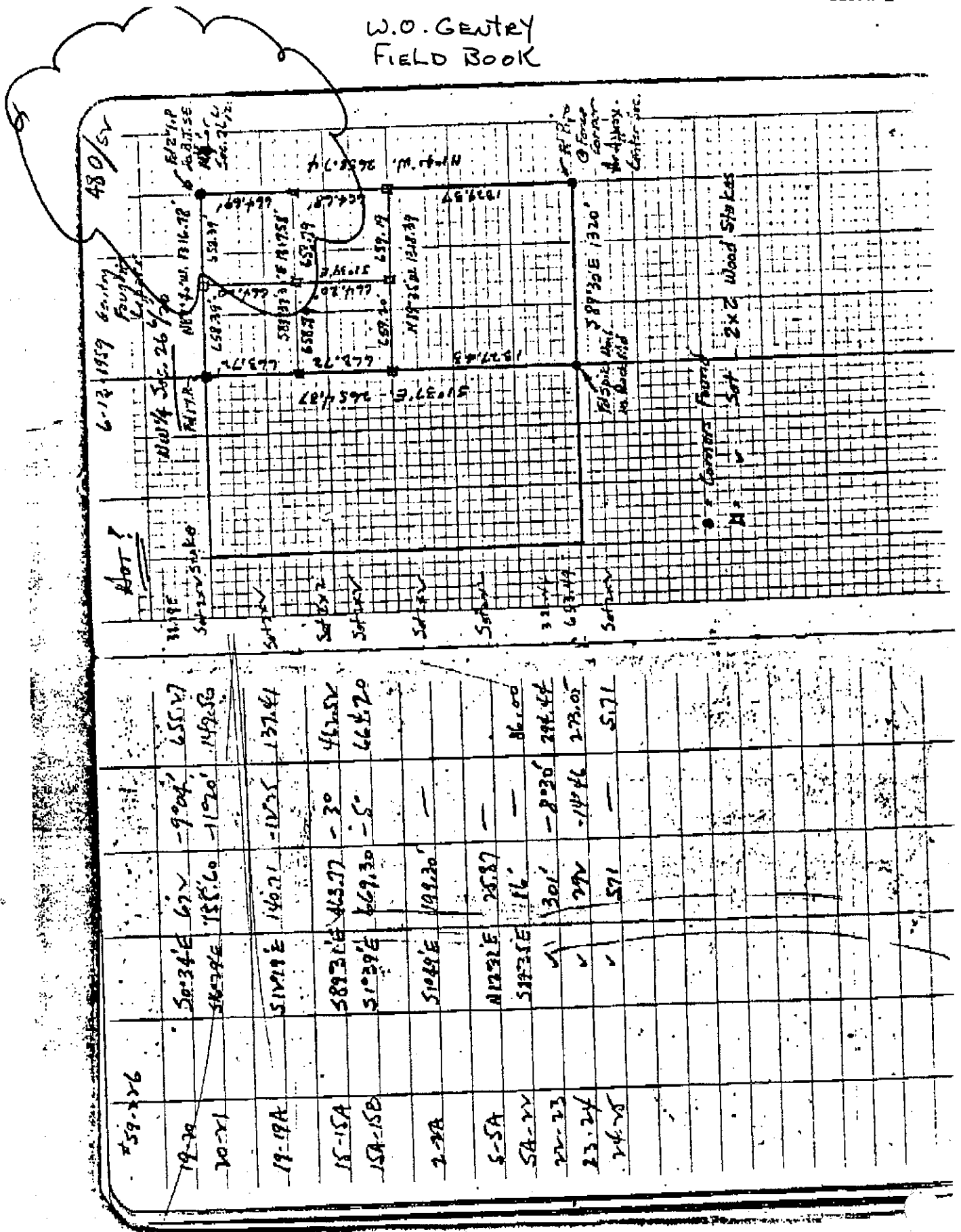

NOT!

480/52

6-12-1959 Gentry  
Fouling  
Lipstick

N 22 1/2° E  
46.31 SE  
N 1/2° W  
50.21 W

N 1/2° W  
1316.78  
N 1/2° W  
1316.78

N 1/2° W  
1316.78  
N 1/2° W  
1316.78

N 1/2° W  
1316.78  
N 1/2° W  
1316.78

N 1/2° W  
1316.78  
N 1/2° W  
1316.78

N 1/2° W  
1316.78  
N 1/2° W  
1316.78

N 1/2° W  
1316.78  
N 1/2° W  
1316.78

N 1/2° W  
1316.78  
N 1/2° W  
1316.78

N 1/2° W  
1316.78  
N 1/2° W  
1316.78

N 1/2° W  
1316.78  
N 1/2° W  
1316.78

N 1/2° W  
1316.78  
N 1/2° W  
1316.78

N 1/2° W  
1316.78  
N 1/2° W  
1316.78

N 1/2° W  
1316.78  
N 1/2° W  
1316.78

59-226

19-20

20-21

19-19A

18-18A

18A-18B

2-2B

5-SA

5A-22

22-23

23-24

24-25

S 20° 34' E  
67.2

S 16° 29' E  
155.60

S 12° 19' E  
140.21

S 8° 23' E  
463.77

S 1° 29' E  
669.30

S 10° 49' E  
199.30

N 12° 31' E  
25.87

S 12° 31' E  
16.00

301'

220'

273.05'

571'

-9° 04'

-1° 20'

-12° 25'

-3° 0'

-5° 0'

-

-

-8° 30'

-14° 46'

-

-

655.17

1492.50

137.84

462.52

664.70

86.00

298.44

273.05

571

0620540300