

Index File No. \_\_\_\_\_

CORNER RECORD (SEARCH)  
(Ref. FSM 7151.4)

Tract or Survey No. \_\_\_\_\_

Cor. SW Coeuer  
No. Sec 24

T 6S R. 20E

R.D. \_\_\_\_\_

County MADERA

Merid. M.D.B. & M.

N.F. SIERRA

State CA

29

CORNER DIAGRAM

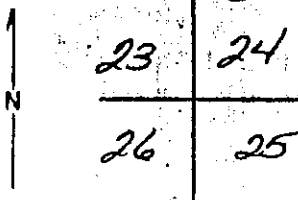

DESCRIBE CORNER MONUMENT FOUND

At SW Coeuer of intersection of Fences to N, S, E & W  
Found 1 1/4" Diameter Iron pipe with nail and tag  
RCE 21650 in a rock mound. Accepted as perpetuation  
of original corner.

DESCRIBE BEARING TREES OR OTHER OFFICIAL ACCESSORIES FOUND

- 1) Found Remains of Oak Stump bearing N 72°06' E, 106.54'  
(Black Oak, 20" Diameter Bears N 71°E, 108.24' GAD)
- 2) Found depression with Oak remains bearing 573°15' E  
71.80' (Black Oak 26" Diameter, Bears 570°E, 75.9' GAD)
- 3) No evidence of other original bearing trees.

DESCRIBE CORNER LOCATION RELATIVE TO NEAR-BY FEATURES, ALSO HOW TO REACH CORNER

From Intersection of Highway 49 and Metcalf  
Gap Rd, Easterly Along A Gravelled Road 1000' ±  
Thence, Southerly Along A Gravelled Road 1300' ±  
Following Signs to "Wallace" Residence, Thence  
Southerly 1300' ± to the CORNER At intersection  
of fences North, South, East, and West.

PHOTO IDENTIFICATION DATA

Photo No. \_\_\_\_\_  
Filed At \_\_\_\_\_  
Object Ident. \_\_\_\_\_  
Ident. By \_\_\_\_\_  
Signature \_\_\_\_\_

PLANE COORDINATE POSITION DATA

State \_\_\_\_\_ Zone \_\_\_\_\_  
X \_\_\_\_\_  
Y \_\_\_\_\_  
Estab. By \_\_\_\_\_  
Agency \_\_\_\_\_

Signature [Handwritten Signature]

Title \_\_\_\_\_ Division \_\_\_\_\_ Headquarters \_\_\_\_\_ Date \_\_\_\_\_ FS-7100-52 (3/68)

LS 5339

CORNER RECORD (PERPETUATION)

MONUMENT: DESCRIBE NEW MONUMENT SET, OR WORK DONE TO PRESERVE EXISTING MONUMENT

Set STANDARD USFS monument, 2 1/2" O.D.  
Aluminum post, 30" long with 3/4" Aluminum  
Cap, in a Rock mound marked:

T6S	R20E
S23	S24
S26	S25

LS 5339  
1989

ACCESSORIES: DESCRIBE NEW BT'S WITNESS OBJECTS ETC. ESTABLISHED, OR WORK DONE TO PRESERVE EXISTING EVIDENCE

- 4) A White Oak, 14" Diameter, Blazed and scribed "NBT" Bears N19°15' E  
122.67'
- 5) A White Oak, 53" Diameter, Blazed and scribed "NBT" Bears N41°33' W 217.55'
- 6) A White Oak, 46" Diameter Blazed and scribed "NBT" Bears 552°23' W  
256.15'
- 7) A METAL Post with USFS signs 54-6 and 54-9, Bears N45° W, 4'

Work Done By B. Seaman Title LS Date 7/13/89 State Registration No. LS 5339  
or Agency \_\_\_\_\_

Certified Cor. Record Prepared? Yes  No  Filed At \_\_\_\_\_ Date \_\_\_\_\_

REMARKS  
Bearings are to center of trees, Distances are horizontal to nail  
and tag LS 5339 driven into the side center of trees 5, 6, and 7  
Posted Forest Service signs 54-9 and 54-3 on all trees