

CORNER RECORD

County of MADERA T. 6 SOUTH R. 20 EAST NDB 1 Meridian California

Corner Type: Govt. Corner Meander Rancho Other

Corner Identification N 1/4 23 1/2 Date of Visit SEPT 19 76



Corner Left as Found Found and Tagged Reestablished Obliterated Corner Rebuilt

Physical Description of Corner Found; Evidence and Method used to Identify or reestablish
1" Iron Pipe Tagged LS 2737 AT FENCE INTERSECTION UP 6" -

Physical Description of Monuments Rebuilt or Perpetuated

California Coordinate System Order: First Second Third

Stations used: NOS (USC & GS) State County Other Station _____ Station _____

Zone _____ Elevation _____ Northings (Y) _____ Eastings (X) _____

SKETCH: (Include reference tie or witness points, remarks and topo of area)

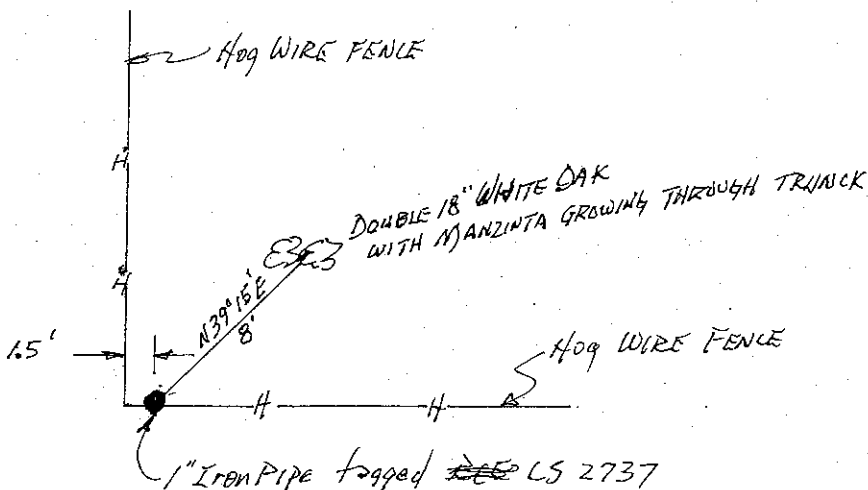

SURVEYOR'S CERTIFICATE

This corner record was prepared by me or under my direction in conformance with the Land Surveyors Act on Sept 19 76.

Signed: Joseph C. Smith CEE 21650

L.S. or R.C.E. No.:

COUNTY SURVEYOR'S CERTIFICATE

The Corner Record was received Sept. 16 19 76 and examined and filed Sept. 22 19 76.

By: A. Grote
 Title County Engineer

Document No. 96.26.3