

Index File No.

CORNER RECORD (SEARCH)
(Ref. FSM 7151.4)

Tract or Survey No.

C-W 1/16 33

Cor. No.

T. _____ R. _____ R.D. _____ County _____
Merid. _____ N.F. _____ State _____

CORNER DIAGRAM

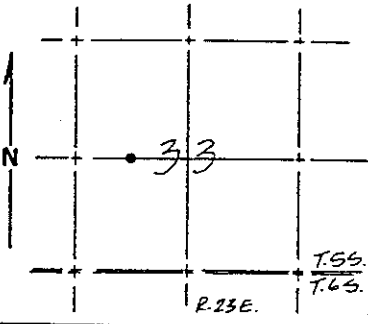

DESCRIBE CORNER MONUMENT FOUND

None found.

DESCRIBE BEARING TREES OR OTHER OFFICIAL ACCESSORIES FOUND

None found.

PHOTO IDENTIFICATION DATA

Photo No. _____
Filed At. _____
Object Ident. _____
Ident. By _____
Signature

DESCRIBE CORNER LOCATION RELATIVE TO NEAR-BY FEATURES, ALSO HOW TO REACH CORNER

Go north on Beasore Road approximately 3/4 mile past Road 6S01 to posted line at driveway to the south. Follow line to the north into meadow to the corner.

PLANE COORDINATE POSITION DATA

State _____ Zone _____
X _____
Y _____
Estab. By _____
Agency

Signature

Title

Division

Headquarters

Date

FS-7100-52 (3/68)

CORNER RECORD (PERPETUATION)

MONUMENT: DESCRIBE NEW MONUMENT SET, OR WORK DONE TO PRESERVE EXISTING MONUMENT

Set U.S.F.S. monument in rock mound marked C-W 1/16 corner Section 33, Township 5 South, Range 23 East.

ACCESSORIES: DESCRIBE NEW BT'S WITNESS OBJECTS ETC. ESTABLISHED, OR WORK DONE TO PRESERVE EXISTING EVIDENCE

I blazed a 17" tamarack South 8° East, 79.73' and a 9" tamarack (twin) North 73° West, 78.97'. I measured North 60° West, 30.40' to a 3/4" I.P. RCE 12406. I set a U.S.F.S. post North 45° West, 4.0'.

Work Done By Jones Title Surveyor Date _____ State Registration No. LS 4298
or Agency _____

Certified Cor. Record Prepared? Yes No Filed At: _____ Date _____

REMARKS

Index File No. T. R. M. Tract or Surv. No. Cor.