

CORNER RECORD

Document Number 591221 G

City of _____ County of Madera, California

Brief Legal Description Portion of Section 7, T.5S., R.23E., M.D.B. & M.

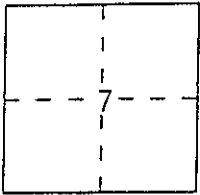

CORNER TYPE

Government Corner Control
Meander Property
Rancho Other
Date of Survey Oct 23, 1995

COORDINATES
(Optional)

N. _____
E. _____
Zone _____ Datum _____
Elev. _____

Corner — Left as found Found and tagged Established Reestablished Rebuilt

Identification and type of corner found: Evidence used to identify or procedure used to establish or reestablish the corner:
Corner No. 1 of the Morning Star Extension per Mineral Survey 5049AB. Found a 4' diameter rock mound. Corner fits bearing and distance relationship to Corner No. 2 and 4 of the Morning Star Ext. and the W 1/2 of Section 7.

A description of the physical condition of the monument as found and as set or reset: Set 5/8" bar with Plastic cap LS 5339 at center of rock mound. Set 20D nail with brass tag LS 5339 at side center of 3 bearing trees.

SURVEYOR'S STATEMENT

This Corner Record was prepared by me or under my direction in conformance with the Land Surveyors' Act on 12/21 1995.

Signed [Signature] L.S. or R.C.E. Number 5339



COUNTY SURVEYOR'S STATEMENT

This Corner Record was received 22 DEC 1995 and examined and filed 29 JAN 1996.

Signed [Signature] Title Act. Co. Surveyor

County Surveyor's Comment _____

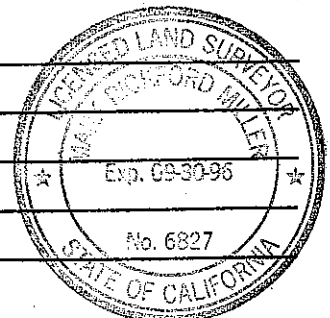



No Scale

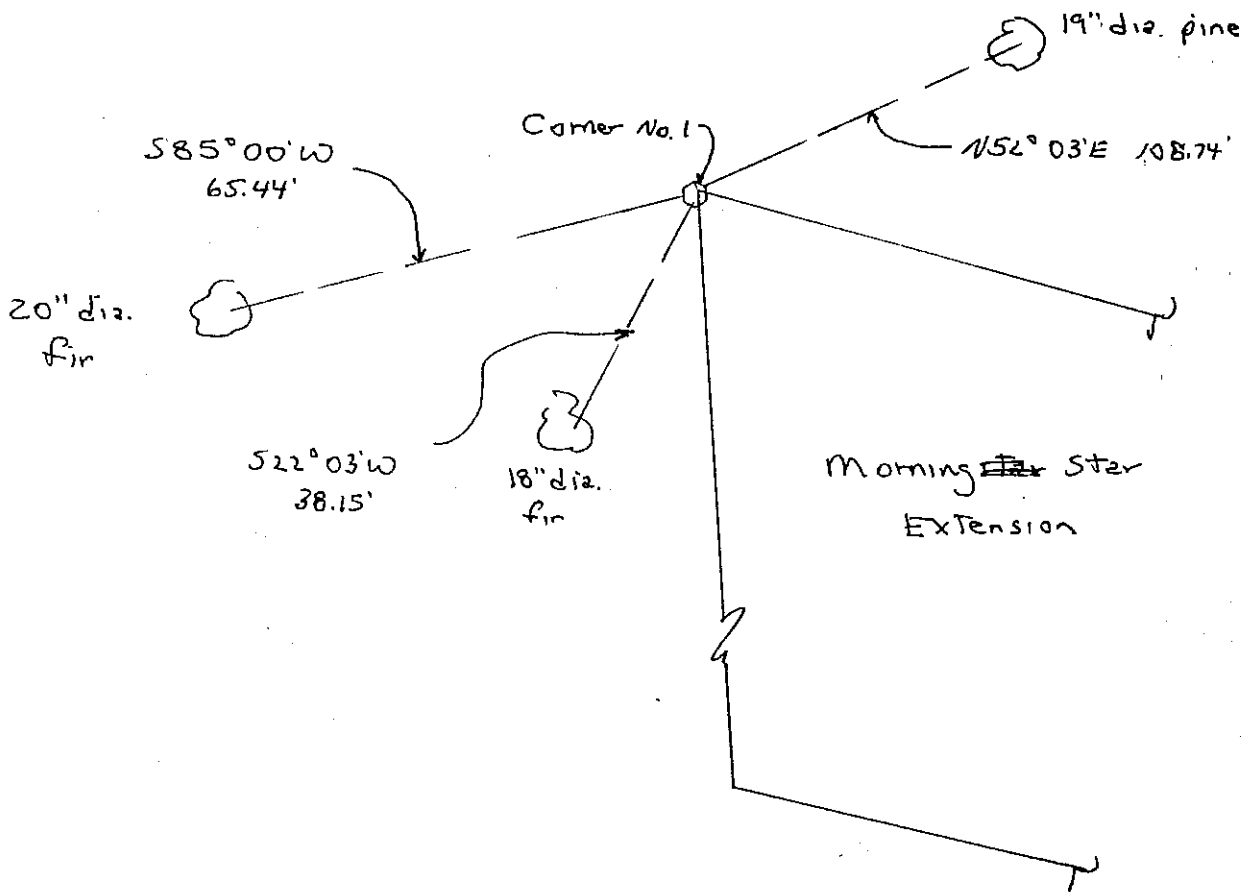

0523