

V:\CAD Files\B Dwg\B-1 4-Inch Masonry Wall.DWG 10-17-11 02:07:22 PM eli.mcfarland

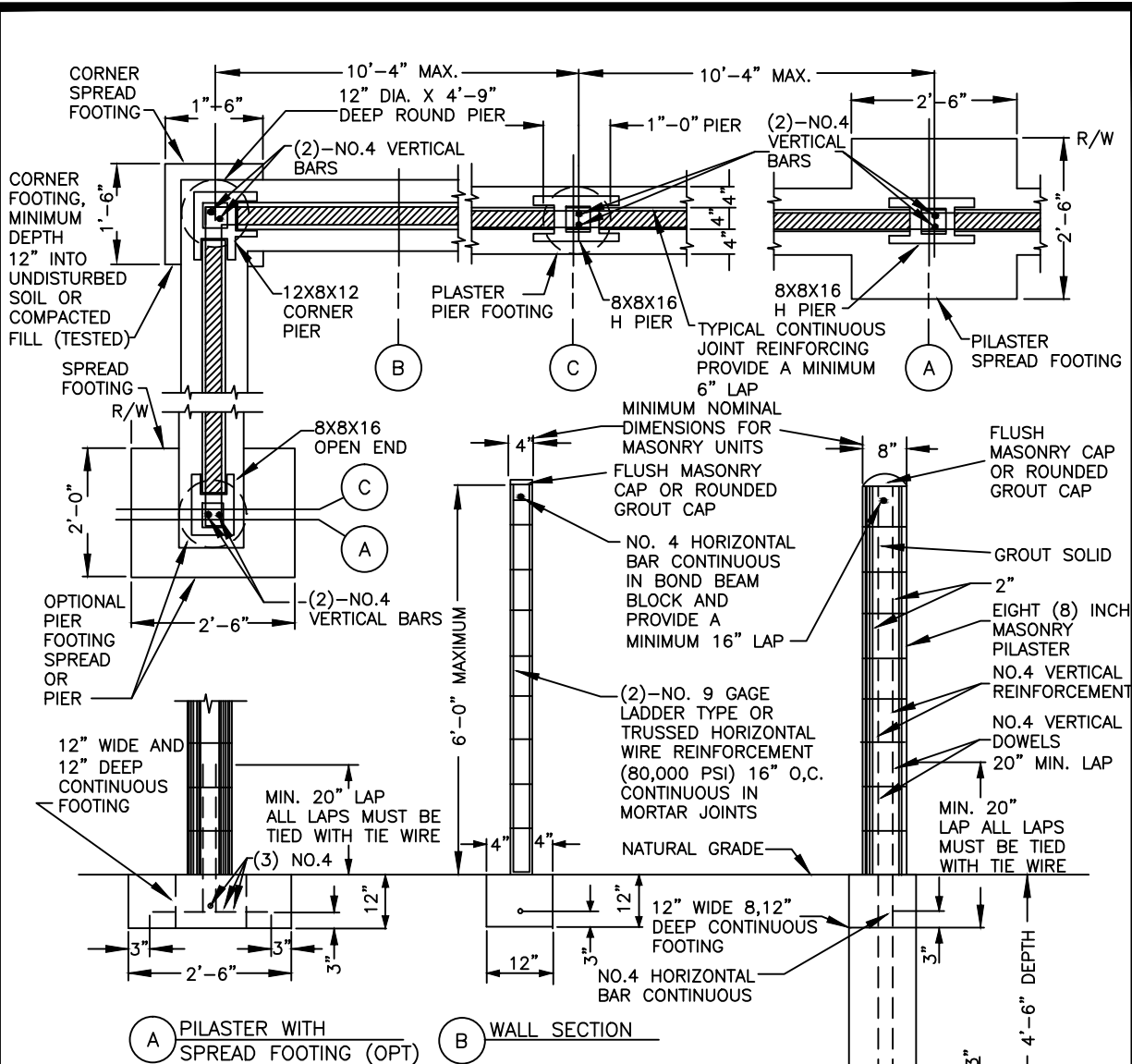

**GENERAL NOTES AND SPECIFICATIONS**

1. ALL CONSTRUCTION SHALL COMPLY WITH THE COUNTY OF MADERA SPECIFICATIONS.
2. GROUT ALL CELLS.
3. ALL MASONRY UNITS SHALL COMPLY WITH THE LATEST ADOPTED UNIFORM BUILDING CODE AND UBC STANDARD 24-4 GRADE N.
4. DEPTH OF FOOTINGS ARE INTO NATURAL UNDISTURBED SOIL OR TESTED AND APPROVED COMPACTED FILL.
5. ALL MASONRY UNITS SHALL BE MINIMUM, t'm = 1350 PSI.
6. REINFORCING STEEL; SHALL BE DEFORMED BARS MINIMUM GRADE 40.
7. FOOTING CONCRETE SHALL BE A (MINIMUM 2500 PSI AT 28 DAYS)
8. THIS DESIGN SHALL NOT BE USED FOR RETAINING EARTH.
9. MORTAR SHALL BE TYPE-S (MINIMUM 1800 PSI AT 28 DAYS)
  - ONE (1) PART CEMENT, TYPE 1
  - ONE-HALF (1/2) PART LIME RUTTY OR HYDRATED LIME
  - FOUR AND ONE-HALF (4 1/2) PARTS SAND (MAXIMUM)
10. GROUT SHALL BE MINIMUM 2000 PSI AT 28 DAYS.
  - ONE (1) PART CEMENT
  - THREE (3) PART SAND
  - TWO (2) PARTS PEA GRAVEL
11. STACK BOND UPON SUBMITTAL ONLY
12. ALL LAPS MUST BE TIED WITH TIE WIRE
13. ALL MASONRY WALLS SHALL BE INSPECTED BY AN AGENCY APPROVED BY THE COUNTY OF MADERA.

Spec's By _____	<b>COUNTY OF MADERA</b>	Date: 07-31-09
Drawn By <u>J. SHIELDS</u>	<b>FOUR (4) INCH MASONRY WALL</b>	Scale: NONE
APPROVED BY _____		Drawing No. B-1
REVISIONS	7/20/2011	